

The Combined Maximum Design Loading for This Pole Assembly per AASHTO 2013 Specifications For A 150 mph Wind Speed Is 3.8 sq. ft. EPA And 95 lbs. Weight.

1. Approximate Pole Assembly Weight: 89 lbs.
2. Maximum Combined Moment At Base: 11867 ft. lbs.
3. Maximum Combined Shear At Base: 652 lbs.

Wind Speed (mph)	130	140	150	160	170	180	190
Maximum EPA (sq. ft.)	10.9	8.7	7.4	6.4	5.5	4.9	4.2

*Tapered Alum. Tube
-.156" Wall Alloy 6063-T6
Standard Powder Coat Finish*

(4) 1"-8NC Galv. Stl. Anchor Bolts,
AASHTO M314-90 Grade 55, 10" Of
Threaded End Galv. Per ASTM A153.
(4) 1"-8NC Galv. Stl. Hex. Nuts
(4) 1" Galv. Stl. Lockwashers
(4) 1" Galv. Stl. Flatwashers

Handhole Frame Tapped 3/8"-16NC
For Grounding

-Reinforced Handhole (4" x 6") With
Cover And Stainless Steel Hex. Hd.
Screws

Base Flange Alloy 356-T6
With Bolt Covers And Stainless
Steel Hex. Hd. Screws

Label Per 38119-002
Part No. 37651, And Manufacture Date

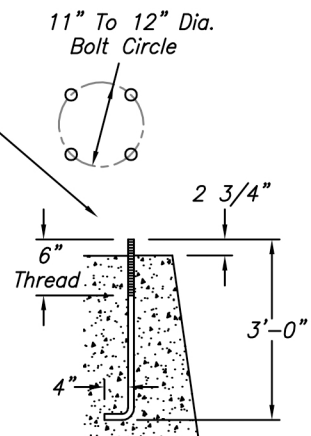
[illegible]

TITLE <i>20' SteadyMax Series Pole</i>	
<i>Part # SP-SM20</i>	
SCALE	DATE
BY	DWG. NO.
CHK'D	