

Parapet HD

Parapet Arm

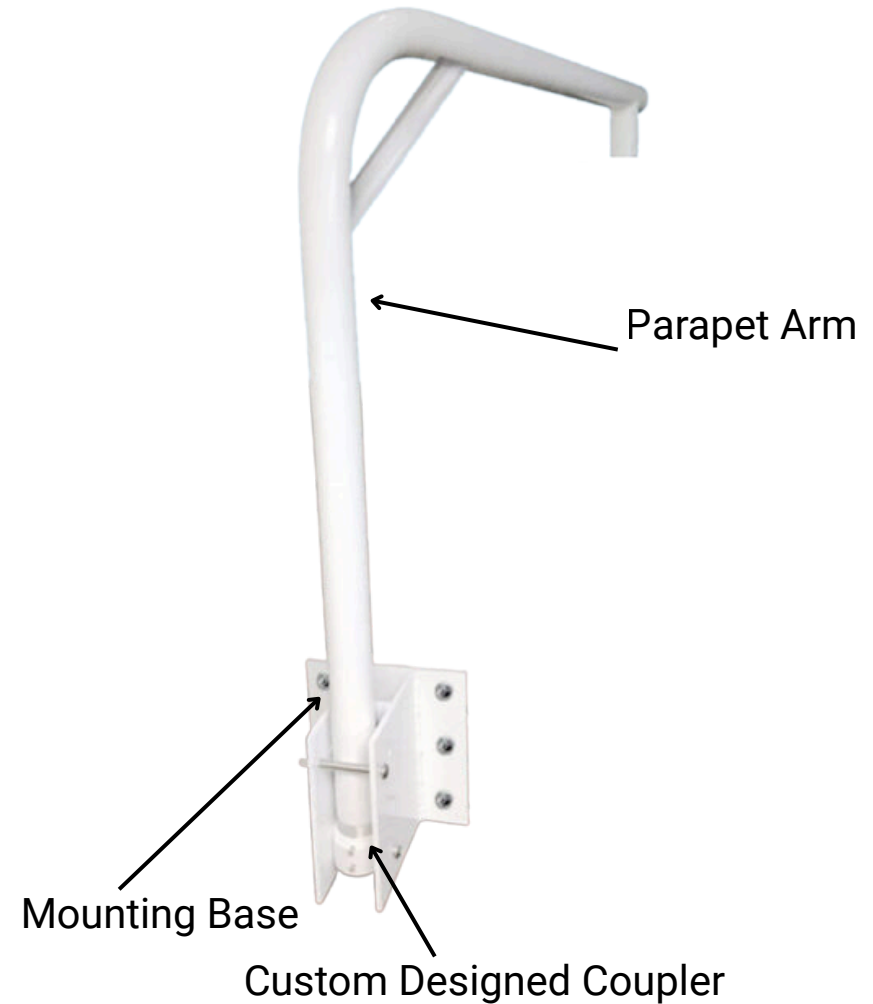
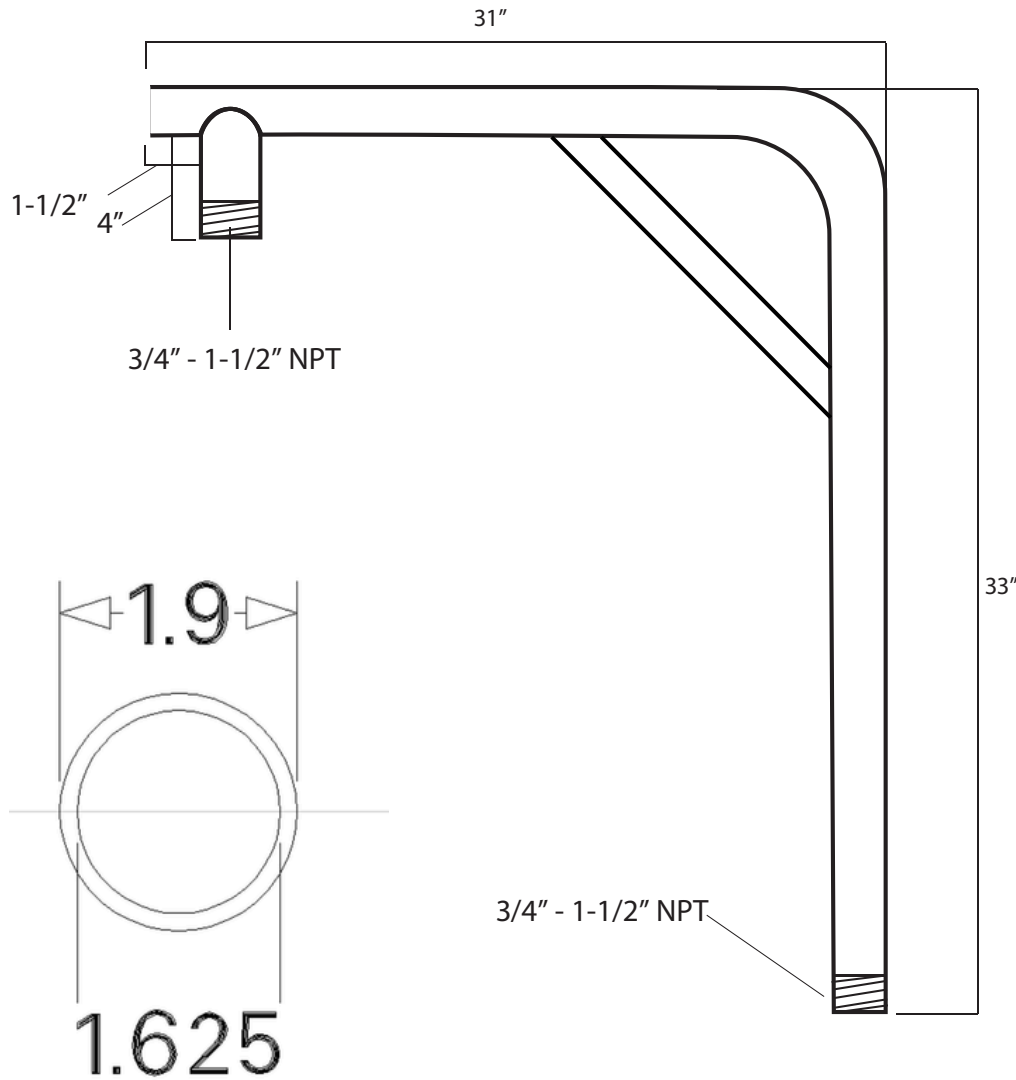

75 lb load capacity

Proprietary Information Notice – Strongpoles

The following materials, including but not limited to engineering designs, technical specifications, manufacturing processes, marketing content, and operational workflows, are considered proprietary and confidential property of Strongpoles Inc.. These assets are protected under applicable intellectual property laws and internal policy frameworks. Unauthorized use, replication, or disclosure of this information is strictly prohibited. Scope of Protected Information Includes: Pole architecture and mounting configurations, Custom hardware details and installation specs, Vendor pricing, distribution strategies, and customer data, Brand creative, campaign concepts, and internal documentation. Access Restrictions: Proprietary information is shared on a need-to-know basis only. All recipients are required to: Maintain confidentiality at all times. Use provided information solely for authorized Strongpoles-related tasks. Immediately report any suspected disclosure or breach. Legal Notice: Violation of this policy may result in disciplinary action, termination of partnership, or legal remedy under IP and trade secret law. Strongpoles reserves the right to pursue damages or injunctive relief where misuse is identified.

Parapet HD

Mounting Base

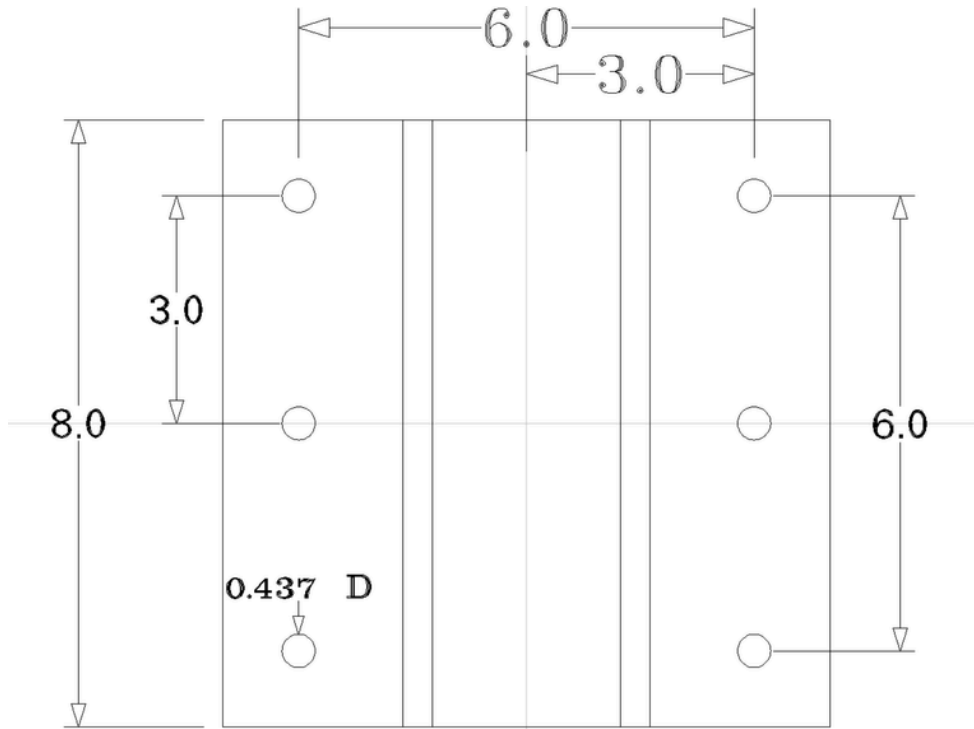

Mounting Base Plate

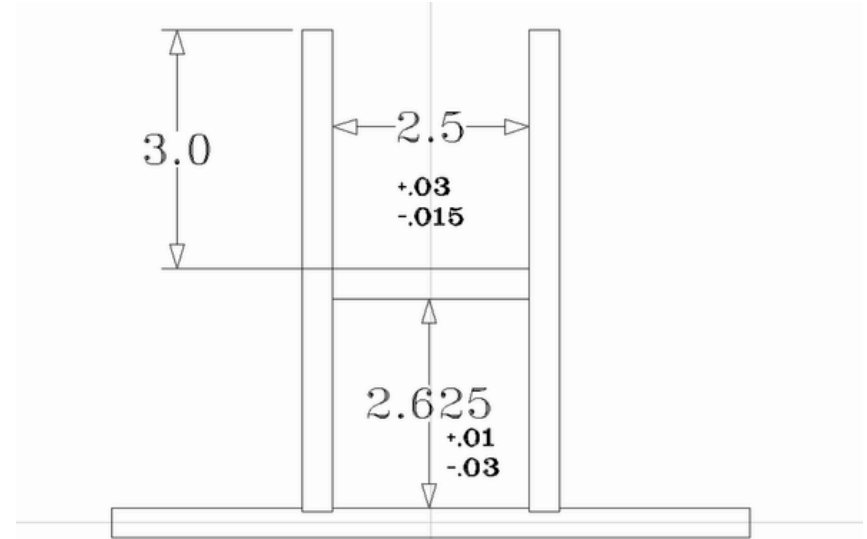

Top View

Side View

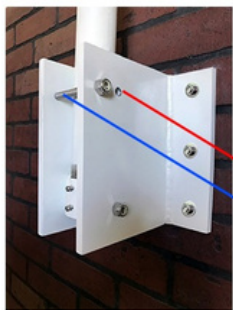
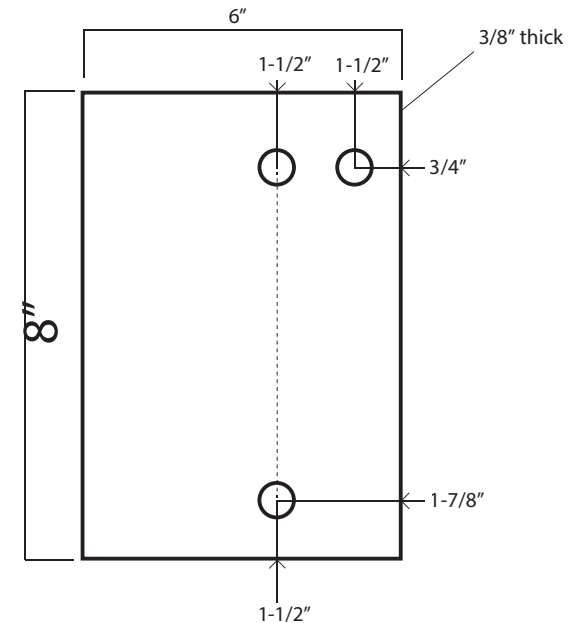

Positioning Lock Bolt Hole

Temporary Positioning Bolt

Proprietary Information Notice – Strongpoles

The following materials, including but not limited to engineering designs, technical specifications, manufacturing processes, marketing content, and operational workflows, are considered proprietary and confidential property of Strongpoles Inc.. These assets are protected under applicable intellectual property laws and internal policy frameworks. Unauthorized use, replication, or disclosure of this information is strictly prohibited. Scope of Protected Information Includes: Pole architecture and mounting configurations, Custom hardware details and installation specs, Vendor pricing, distribution strategies, and customer data, Brand creative, campaign concepts, and internal documentation. Access Restrictions: Proprietary information is shared on a need-to-know basis only. All recipients are required to: Maintain confidentiality at all times. Use provided information solely for authorized Strongpoles-related tasks. Immediately report any suspected disclosure or breach. Legal Notice: Violation of this policy may result in disciplinary action, termination of partnership, or legal remedy under IP and trade secret law. Strongpoles reserves the right to pursue damages or injunctive relief where misuse is identified.